

K

J

I

H

G

F

E

D

C

B

A

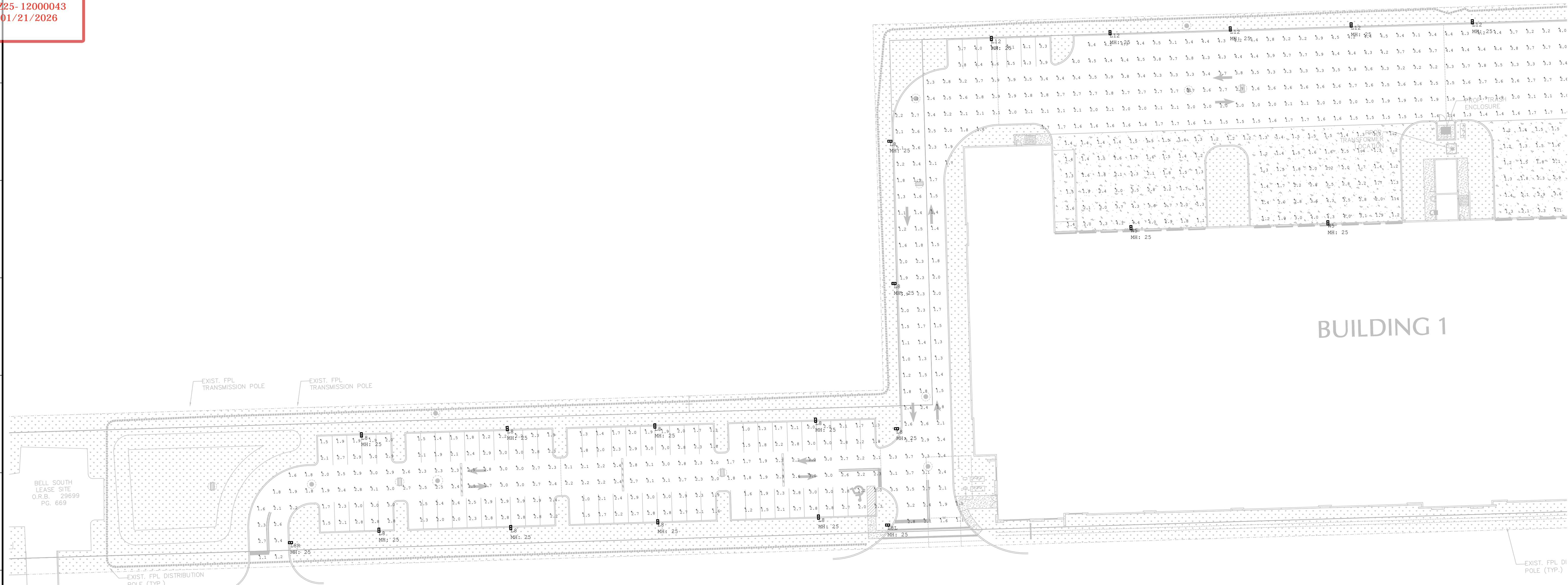

1 PHOTOMETRIC SITE PLAN

ESP-1 SCALE: 1"=30'-0"

Luminaire Schedule									
Symbol	Qty	Label	Arrangement	Luminaire Lumens	LLF	Luminaire Watts	Total Watts	Description	[MANUFAC]
	5	W8	Single	8541	0.900	74.41	372.05	OPF-M-A08-840-BLC	SIGNIFY CANADA LTD
	15	L12	Single	16466	0.900	150.2	2253	OPF-M-A12-840-BLC	SIGNIFY CANADA LTD
	11	L8	Single	8541	0.900	74.41	1116.15	OPF-M-A08-840-BLC	SIGNIFY CANADA LTD
	3	L8L	Single	6665	0.900	74.41	223.23	OPF-M-A08-840-LCL	SIGNIFY CANADA LTD
	3	L8R	Single	6665	0.900	74.41	223.23	OPF-M-A08-840-LCR	SIGNIFY CANADA LTD
	8	W5	Single	15379	0.900	104.3	834.4	OPF-S-A05-840-T4M	SIGNIFY CANADA LTD

Calculation Summary										
Label	CalcType	Units	Avg	Max	Min	Avg/Min	Max/Min	Point Spacing	Calc. Plane Height	
Loading Docks Bldg 1	Illuminance	Fc	2.00	4.4	1.1	1.82	4.00	10	0	
Loading Docks Bldg 2	Illuminance	Fc	2.81	4.9	1.1	2.55	4.45	10	0	
Parking and Drive Lanes	Illuminance	Fc	2.79	5.6	1.0	2.79	5.60	10	0	
Property Line	Illuminance	Fc	0.11	0.5	0.0	N.A.	N.A.	N.A.	N.A.	

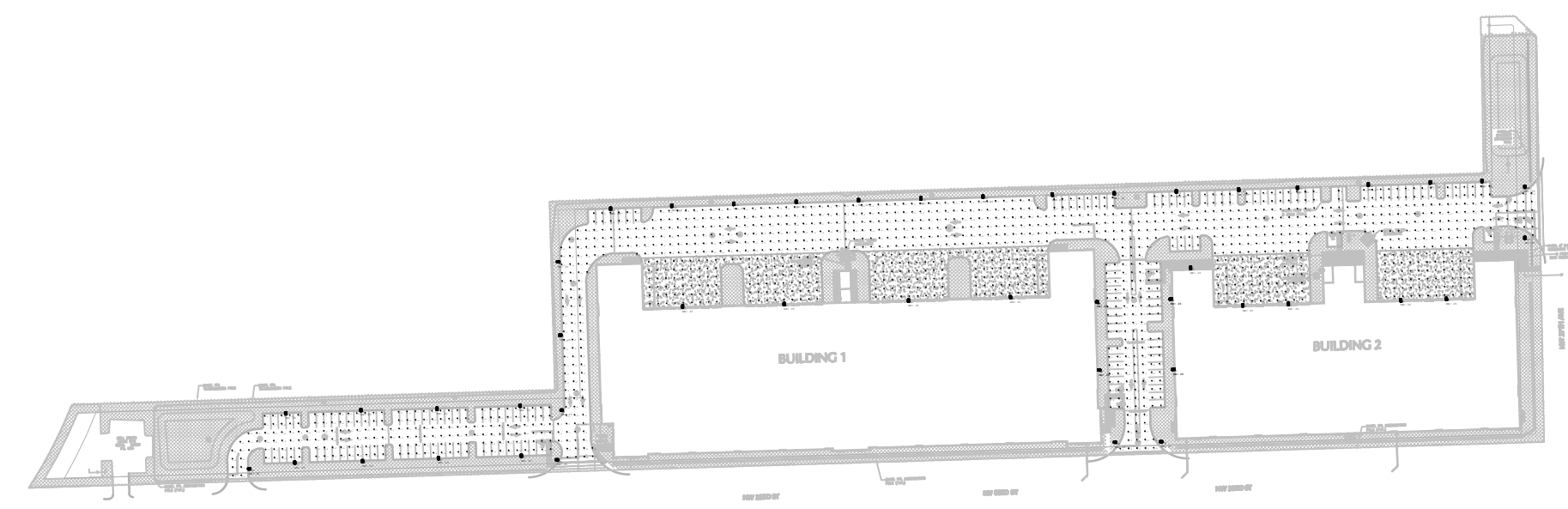

REVISIONS

Drawing Title

PHOTOMETRIC
SITE PLAN

Scale AS NOTED
Project No. 25046
Date 11/06/2025

Principal: CSM
Project Director:
Project Manager:
Drafted by:
Checked by:

Sheet No.

ESP-1

Festival Flea Market South
Shell Industrial Buildings
NW 27th Ave + NW 33rd St Pompano Beach, FL
FOUNDRY COMMERCIAL

J. DAVID PUGA
LICENSE
NO. 41163
STATE OF
FLORIDA
PROFESSIONAL ENGINEER

THIS ITEM HAS BEEN DIGITALLY SIGNED AND
SEALED BY JUAN DAVID PUGA ON THE DATE
ADJACENT TO THE SEAL. PRINTED COPIES OF
THIS DOCUMENT ARE NOT CONSIDERED SIGNED
AND SEALED AND THE SIGNATURE MUST BE
VERIFIED ON ANY ELECTRONIC COPIES.

17001 N. Federal Highway, Suite B-205,
Boca Raton, FL 33487
Tel: 561-933-0999
COPYRIGHT CMBE ARCHITECTURE, LLC 2006
THE DRAWINGS AND ALL THE IDEAS, ARRANGEMENTS,
DESIGNS AND PLANS INDICATED THEREON OR
REPRESENTED THEREBY ARE OWNED BY AND REMAIN THE
PROPERTY OF CMBE ARCHITECTURE, LLC AND NO PART
HEREOF SHALL BE REPRODUCED OR TRANSMITTED IN ANY
FORM OR BY ANY MEANS, ELECTRONIC OR MECHANICAL,
INCLUDING PHOTOCOPYING, RECORDING, OR BY ANY
INFORMATION STORAGE AND RETRIEVAL SYSTEM, OR
FOR ANY PURPOSE WHATSOEVER EXCEPT
WITH THE SPECIFIC WRITTEN PERMISSION OF CMBE
ARCHITECTURE, LLC.

C M B E
ARCHITECTURE